

CAPILLARY REDUCING TEE

COMPLY WITH BSEN1254-1:1998

COMPONENTS PARTS

| PARTS | MATERIAL |
|-------------|----------|
| REDUCER TEE | COPPER |

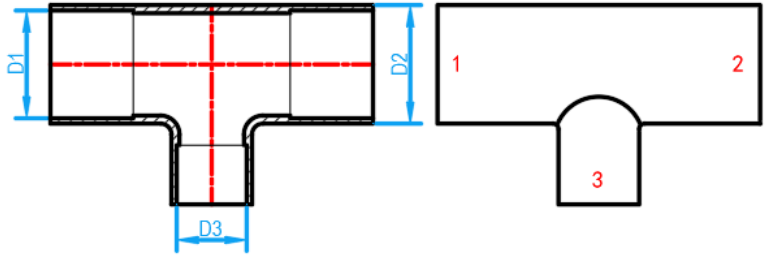

CROSS SECTIONAL VIEW

DIMENSIONS

| SKU | D1 (mm) | D2 (mm) | D3 (mm) | WEIGHT (Kg) | PCS/CTN |
|--------------|---------|---------|---------|-------------|---------|
| MBLRT0151520 | 15 | 15 | 22 | 0.039 | 350 |
| MBLRT0201515 | 22 | 15 | 15 | 0.041 | 300 |
| MBLRT0202015 | 22 | 22 | 15 | 0.039 | 350 |
| MBLRT0202025 | 22 | 22 | 28 | 0.041 | 150 |
| MBLRT0201520 | 22 | 15 | 22 | 0.052 | 250 |
| MBLRT0252015 | 28 | 22 | 15 | 0.063 | 150 |
| MBLRT0252020 | 28 | 22 | 22 | 0.077 | 160 |
| MBLRT0252025 | 28 | 20 | 28 | 0.083 | 130 |
| MBLRT0252515 | 28 | 28 | 15 | 0.052 | 200 |
| MBLRT0252520 | 28 | 28 | 22 | 0.065 | 150 |
| MBLRT0352515 | 35 | 28 | 15 | 0.135 | 130 |
| MBLRT0352525 | 35 | 28 | 28 | 0.128 | 130 |
| MBLRT0352535 | 35 | 28 | 35 | 0.134 | 130 |
| MBLRT0353515 | 35 | 35 | 15 | 0.098 | 130 |
| MBLRT0353520 | 35 | 35 | 22 | 0.092 | 110 |
| MBLRT0353525 | 35 | 35 | 28 | 0.117 | 80 |
| MBLRT0424215 | 42 | 42 | 15 | 0.134 | 60 |
| MBLRT0424220 | 42 | 42 | 22 | 0.134 | 60 |
| MBLRT0424225 | 42 | 42 | 28 | 0.152 | 50 |
| MBLRT0424235 | 42 | 42 | 35 | 0.173 | 50 |
| MBLRT0505015 | 54 | 54 | 15 | 0.231 | 50 |
| MBLRT0505020 | 54 | 54 | 22 | 0.242 | 48 |
| MBLRT0505025 | 54 | 54 | 28 | 0.248 | 36 |

DIMENSIONS

| SKU | D1 (mm) | D2 (mm) | D3 (mm) | WEIGHT (Kg) | PCS/CTN |
|----------------|---------|---------|---------|-------------|---------|
| MBLRT0505035 | 54 | 54 | 35 | 0.287 | 32 |
| MBLRT0505042 | 54 | 54 | 42 | 0.316 | 32 |
| MBLRT0656515 | 67 | 67 | 15 | 0.330 | 32 |
| MBLRT0656520 | 67 | 67 | 22 | 0.380 | 30 |
| MBLRT0656525 | 67 | 67 | 28 | 0.404 | 25 |
| MBLRT0656535 | 67 | 67 | 35 | 0.452 | 25 |
| MBLRT0656542 | 67 | 67 | 42 | 0.496 | 20 |
| MBLRT0656550 | 67 | 67 | 54 | 0.536 | 15 |
| MBLRT0808015 | 76 | 76 | 15 | 0.457 | 24 |
| MBLRT0808020 | 76 | 76 | 22 | 0.558 | 20 |
| MBLRT0808025 | 76 | 76 | 28 | 0.538 | 20 |
| MBLRT0808035 | 76 | 76 | 35 | 0.515 | 20 |
| MBLRT0808042 | 76 | 76 | 42 | 0.556 | 15 |
| MBLRT0808050 | 76 | 76 | 54 | 0.630 | 15 |
| MBLRT0808065 | 76 | 76 | 67 | 0.724 | 12 |
| MBLRT10010025 | 108 | 108 | 28 | 1.120 | 8 |
| MBLRT10010035 | 108 | 108 | 35 | 1.205 | 6 |
| MBLRT10010042 | 108 | 108 | 42 | 1.430 | 6 |
| MBLRT10010050 | 108 | 108 | 54 | 1.600 | 5 |
| MBLRT10010065 | 108 | 108 | 67 | 1.565 | 5 |
| MBLRT10010080 | 108 | 108 | 76 | 2.148 | 5 |
| MBLRT15015050 | 108 | 108 | 54 | 2.500 | 2 |
| MBLRT150150100 | 159 | 159 | 108 | 4.000 | 2 |